

CGLine+ Web-Controller with integrated web server

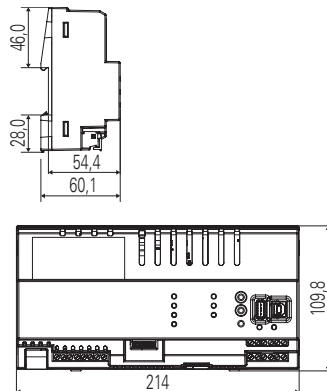

Dimensional drawings, data in mm



CGLine+ Web-Controller

- For connecting up to 800 luminaires in max. 4 lines
- The integrated web server enables there to be convenient visualization, control and monitoring
- Unique ID per luminaires assigned by the manufacturer
- Automatic luminaire search function requiring no manual addressing
- Simple sorting using unrestricted short address assignment
- Unrestricted entry of target location names for the luminaires with up to 20 characters
- Clearly-shown allocation of luminaires to up to 8 zones per line
- Automatic function test and duration test
- Up to 8 test groups per luminaire can be defined for the function test (FT) and duration test (DT)
- Electronic log book storage for a period of minimum 4 years
- E-mail service for sending automatic e-mail in case of malfunctions to up to 10 e-mail addresses, assignable to 2 escalation groups
- Blocking the emergency lighting function during non-operational periods (all / per bus line/ per zone / per luminaire)
- Luminaires in maintained mode switchable (all / per bus line / per zone / per luminaire)
- Password protected access as an administrator or user
- Visualization of luminaires in up to 30 different building layouts
- Efficient and convenient analysis of the log book using the CGLine+ PC software

Dimensions	214 x 109.8 x 60.1 mm
Housing type	For DIN rail 12 TE
Power supply	230 V AC, 50/60 Hz
Power consumption	< 4 W in standby, < 21 W at full load
Connection terminals	max. 2.5 mm ²
Permissible ambient temperature	0 °C ... 35 °C
Storage temperature	-20 °C ... 70 °C
Degree of protection	IP20

Ordering details

Type	Scope of supply	Order No.
CGLine+ Web-Controller	Module in installation housing for DIN rails	40071361787

Accessories

Type	Scope of supply	Order No.
CGLine+ PC software	on CD-ROM	40071361178

CGLine+ Touchscreen Controller



Dimensional drawing Controller, data in mm

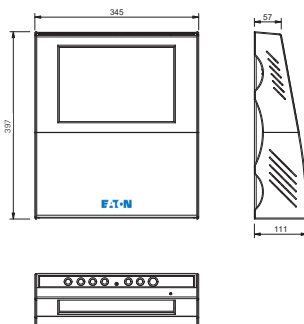

CGLine+ Touchscreen Controllers

- 10,1 inch Touchscreen IPS display with WIN10
- For connecting up to 800 luminaires in max. 4 lines
- Unique ID per luminaire assigned by the manufacturer
- Automatic luminaire search function requiring no manual addressing
- Simple sorting using unrestricted short address assignment
- Unrestricted entry of target location names for the luminaires with up to 20 characters
- Clearly-shown allocation of luminaires to up to 16 zones per line
- Automatic function and duration test of luminaires, with customisable time/date settings
- Up to 8 test groups per luminaire can be defined for the function test (FT) and duration test (DT)
- Electronic log book storage for a period of minimum 4 years
- Blocking the emergency lighting function during non-operational periods (all / per bus line/ per zone / per luminaire)
- Luminaires in maintained mode switchable (all / per bus line / per zone / per luminaire)
- Password protected access as an administrator or user
- Visualization of luminaires in up to 30 different building layouts
- Efficient and convenient analysis of the log book using the CGLine+ PC software

CGL+ CGVision Touchscreen G/Controller - Specific features :

- Ethernet connection
- CGVision Touchscreen Software allows full configuration and visualisation of the integrated CGLine+ Web Controller and up to 9 external controllers/installations via ethernet.
- E-mail service for sending automatic e-mail in case of malfunctions to up to 10 e-mail addresses, assignable and 2 escalation groups

Dimensions in mm (H x W x D)	345 x 397 x 111
Housing type	Plastic, wall-mounted housing
Power supply	230 V AC, 50/60 Hz
Power consumption	< 12 watts standby < 38 watts full load
Connection terminals	max. 2.5 mm ² flexible
Permissible Ambient temperature	0 ° to 35 °C
Storage temperature	0 ° to 35 °C
Degree of protection	IP 20

Ordering details

Type	Scope of supply	Order No.
CGL+ CGVision Touchscreen G/Controller	CGL+ CGVision Touchscreen G/Controller: Group visualisation with full configuration and monitoring of up to 9 external CGL+ Controllers	40071777997-C

Accessory

Type	Scope of supply	Order No.
CGLine+ PC software	on CD-ROM	40071361178

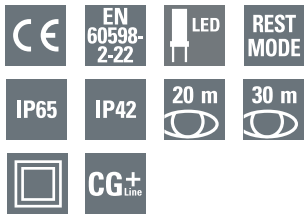

SafeLite



SafeLite 20m

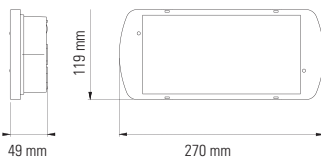

SafeLite 30m

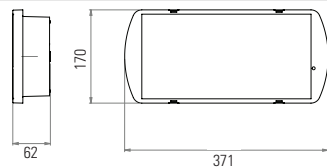

Recessed Base



Cone diffuser



Plexi plate diffuser



SafeLite

Function	Use either as an emergency luminaire or exit sign
Testing system	Stand Alone
Housing	Polycarbonate, Glow wire test : 850°C, RAL9003
Type of mounting	Surface Options : Recessed base for ceiling, double sided cone diffuser, plexi plate diffuser, set of 3 exit legends (L, R, D)
Terminals	up to 1x2,5 mm ² per connection
Degree of protection	IK04, IP42 or IP65
Operation Mode	Non Maintained or Maintained & Non Maintained mode selectable
Connection voltage	230V +/- 5% [220V-240V] 50-60Hz
Permissible ambient temperature	+5°C to +40°C
Battery	Ni-Cd
Light source	LED strip
Duration	3 hours
Viewing distance	20m or 30m
Insulation class	II
Dimensions in mm	20 m viewing distance version: 270 x 119 x 49 30 m viewing distance version: 371 x 170 x 62

Order codes

Order code	Description	Viewing distance	Operation	IP	Lum in emergency	Lum in mains	IK	Duration	Battery	Weight (kg)
SL2-42D3D-CGL-C	SL20,MNM,IP42,100lm,3H	20m	MNM	42	100	100	04	3h	3.6V 1.7Ah	0.7
SL2-65D3D-CGL-C	SL30,MNM,IP42,200lm,3H	20m	MNM	65	100	100	07	3h	3.6V 1.7Ah	0.7

Accessories

SL23A	20m adhesive pictograms (L,R,D)
SL33A	30m adhesive pictograms (L,R,D)
SL23I	20m 3x Foils to insert inside the luminaire (L, R, D)
SL33I	30m 3x Foils to insert inside the luminaire (L, R, D)
SL3PPD	30m Plexi Plate 1 side down
SL3PPDD	30m Plexi Plate 2 sides down
SL3PPLR	30m Plexi Plate 2 sides L,R
SL2PPD	20m Plexi Plate 1 side down
SL2PPDD	20m Plexi Plate 2 sides down
SL2PPLR	20m Plexi Plate 2 sides L,R
SL2CD	SL20,Cone Diffuser*
SL3CD	SL30, Cone Diffuser*
SL2RB	SL20,Recessed Base, Plastic, RAL9003
SL3RB	SL30,Recessed Base, Plastic, RAL9003

*Pictograms have to be ordered separately

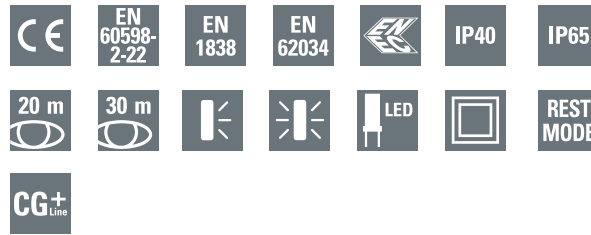
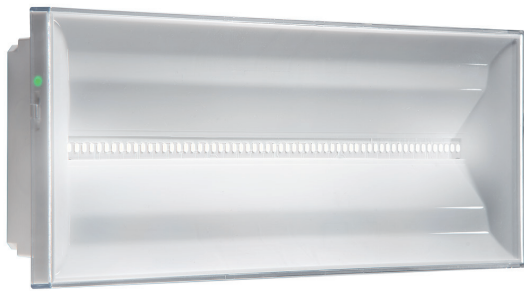

- From 150 to 300lm output flux
- Comparable to 8, 11 and 18W fluorescent lamp
- Ni-Cd HT high quality batteries

Light Source:

LED strip

Material:

Base and reflector white polycarbonate

Diffuser clear polycarbonate

Protection degree IP40 and IP65 with the accessory kit

Installation options:

Wall and ceiling mounting

Surface or recessed installation in false ceiling and bricks wall

Single side glue-less ISO7010 pictograms with

20m viewing distance

Double side ISO7010 panels with 30m of viewing distance

Reliability and continuity of service was the main consideration in the development of the new NexiTech LED Emergency lighting range.

The modern style, the simplicity of the shapes and the high quality surfaces make NexiTech LED ideal for any architectural context, while the precision of the mechanics and the sophisticated electronics guarantee a full unmatched reliability.

The latest generation of LED light source and the careful study of the refractive parts allow a uniform light distribution without light waste.

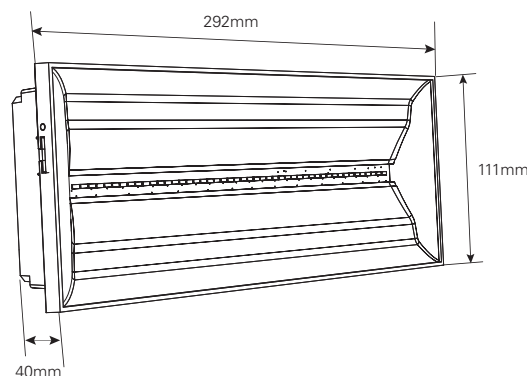

Operation:

Maintained and Non-Maintained mode on all version

Fixed 60lm output in Maintained mode for all variants for high energy saving

3h duration

Rest Mode and Tests via remote command

24h for 3h versions

Autotest is now for all

The reliability and the guarantee of operation are now within everyone's reach. We chose to design NexiTech LED starting directly from models with built-in diagnostic functions, all the self-contained versions (with battery on board) are equipped with a self-test system that performs automatic tests in accordance with standard EN62034 and EN50172.

Top level signalization

The pictograms, optional and available upon request, conform to the international standard ISO7010, have no glue and can be repositioned at will and with ease, without a complex installation. They are placed between the diffuser and reflector creating a translucency which finds its maximum aesthetic applications when recessed into the wall.

Applications:

Schools, universities, commercial malls, stores, offices, public administration and all indoor generic environments

Safety antipanic lighting and escape route lighting

Hi-bay environments



NexiTech LED with IP65 protection kit

The IP65 kit is compatible with all the variants.
Only surface mounting. Dimension 308x125x53 mm

Emergency safety and exit signs

NexiTech LED



With double-side pictograms



Viewing distance: 30m

With single-side pictograms



Viewing distance: 20m





Recessed base for bricks wall



Order code: NEXI-RB
Cut-out: 277x100 mm

Nexi LED frame







Order code	Description					
NEXI150-3H-CGL-C	NexiTech LED 150 3h CGLLine+	1.3 W - 3.1 W	150 Lm	3h	7.2V - 1.7Ah NiCd	Maintained / Non-Maintained
NEXI150-3H-CGL-IP-C	NexiTech LED 150 3h IP65 CGLLine+	1.3 W - 3.1 W	150 Lm	3h	7.2V - 1.7Ah NiCd	Maintained / Non-Maintained
NEXI300-3H-CGL-C	NexiTech LED 300 3h CGLLine+	2 W - 3.2 W	300 Lm	3h	7.2V - 1.7Ah NiCd	Maintained / Non-Maintained
NEXI300-3H-CGL-IP-C	NexiTech LED 300 3h IP65 CGLLine+	2 W - 3.2 W	300 Lm	3h	7.2V - 1.7Ah NiCd	Maintained / Non-Maintained

*Non maintained - Maintained

Accessories



NEXI-IP	IP65 protection kit
NEXI-RB	Bricks wall recessed base (cut-out 277x100mm)
NEXI-FC	False ceiling adapter (cut-out 272x95mm)
NEXI-FR	Finishing frame NexiTech LED
LUM10312	Rest-Mode and Test telecommand

Single-side pictograms

NEXI-PICTO-D	Pictogram Down ISO single-side 20m	
NEXI-PICTO-L	Pictogram Left ISO single-side 20m	
NEXI-PICTO-R	Pictogram Right ISO single-side 20m	
NEXI-PICTO-U	Pictogram Up ISO single-side 20m	

Double-side panels

Ultra version - high uniformity - compatible IP40 housing

NEXI-PLEX-DD	Double side panel Down/Down ISO 30m	
NEXI-PLEX-LR	Double side panel Left/Right ISO 30m	
NEXI-PLEX-DB	Double side panel Down/Blind ISO 30m	
NEXI-PLEX-UU	Double side panel Up/Up ISO 30m	
NEXI-PLEX-UB	Double side panel Up/Blind ISO 30m	

i-P65+ with Polycarbonate enclosure

Crompton

Self-contained luminaires



i-P65+

- LED safety luminaire with high ingress protection class (IP65) for both indoor and outdoor use
- Robust design (IK08) made from impact-resistant polycarbonate
- i-P65+ L: with wide-beam symmetrical lense with a near-square light distribution, i-P65+ L variant is suitable for illuminating large areas (Spacing in both direction up to 22 m for E= 1lx) and mounting heights up to 18 m (for 1 h rated operating time)
- i-P65+ H: With narrow-beam reflector technology, the i-P65+ H variant is especially suitable for escape route lighting with high spacing up to 29 m and mounting heights up to 21 m (for 1 h rated operating time)
- High lumen output ensures additional suitability for increased illumination levels such as min. 15 lx for high risk task areas or applications with 10.8 lx acc. to NFPA 101
- With provisions for M20 cable entries on enclosures sides (3 x lateral and 1 x at each end side) and BESA entry on rear
- Minimum maintenance effort and increased safety via use of LEDs with high service life (up to 60,000 h)
- Suitable for non-maintained and maintained operation

i-P65+ L variant



i-P65+ H variant



Dimensions in mm

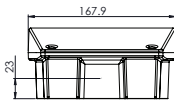
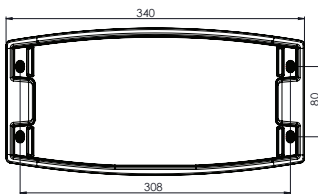
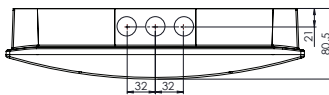

Mounting bracket

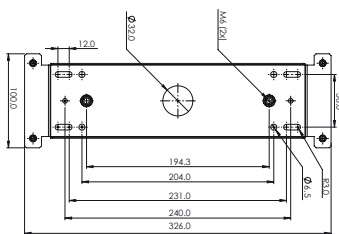
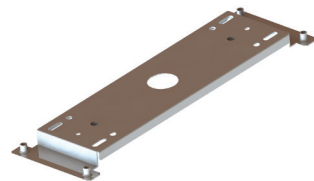

Function	L variants = Anti Panic, Escape Route	H variants = Escape Route
Testing system	Addressable (CGLine+)	
Housing	Polycarbonate, Glow wire test : 850°C, RAL9016	
Type of mounting	Surface ceiling	
Terminals	Plug-in Terminals - 0.5 - 2.5 mm ²	
Operation Mode	Maintained & Non Maintained mode selectable	
Connection voltage	230-240V - 50/60 Hz	
Permissible ambient temperature	+5°C to +40°C	
Battery	Ni-Cd	
Light source	COB LED 6.5W	
Insulation class	I	
Dimensions in mm	340 x 168 x 80.5	
Weight (kg)	1.75	

Ordering details

Order code	Monitoring	Optics	Duration	Lum in emergency mode	Lum in mains mode	Consumption				Battery	
						Non Maintained mode	Maintained mode				
iP65PLP3HCGLC	CGLine+	Lens (L)	3h	510	900	4.4 VA	3.2 W	21.7 VA	10.7 W	4.8 V	4 Ah
iP65PHP3HCGLC		Reflector (H)	3h	380	690	4.4 VA	3.2 W	21.7 VA	10.7 W	4.8 V	4 Ah

One M20 cable gland included

Accessories

Order code	Scope of supply
IP65PSUSPB	Mounting bracket for chain suspension or for mounting at trunking systems or similar

Crompton

- LED safety luminaire with high ingress protection class (IP65) for both indoor and outdoor use
- Robust design (IK08) made from aluminium die-cast and impact-resistant polycarbonate
- i-P65+ L: with wide-beam symmetrical lense with a near-square light distribution, i-P65+ L variant is suitable for illuminating large areas (Spacing in both direction up to 22 m for E= 1lx) and mounting heights up to 18 m (for 1 h rated operating time)
- i-P65+ H: With narrow-beam reflector technology, the i-P65+ H variant is especially suitable for escape route lighting with high spacing up to 29 m and mounting heights up to 21 m (for 1 h rated operating time)
- High lumen output ensures additional suitability for increased illumination levels such as min. 15 lx for high risk task areas or applications with 10.8 lx acc. to NFPA 101
- With provisions for M20 cable entries on enclosures sides (3 x lateral and 1 x at each end side) and BESA entry on rear
- Minimum maintenance effort and increased safety via use of LEDs with high service life (up to 60,000 h)
- Suitable for non-maintained and maintained operation

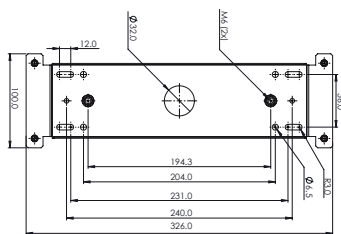
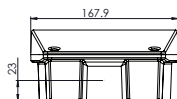
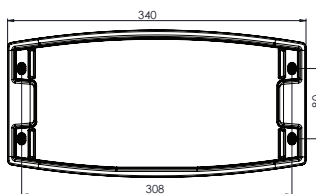

Function	L variants = Anti Panic, Escape Route	H variants = Escape Route
Testing system	CGLine+	
Housing	Aluminium, Polycarbonate, Glow wire test : 850°C, RAL9016	
Type of mounting	Surface ceiling	
Terminals	Plug-in Terminals - 0.5 - 2.5 mm²	
Operation Mode	Maintained & Non Maintained mode selectable	
Connection voltage	230-240V - 50/60 Hz	
Permissible ambient temperature	+5°C to +40°C	
Battery	Ni-Cd	
Light source	COB LED 6.5W	
Insulation class	I	
Dimensions in mm	340 x 168 x 80.5	
Weight (kg)	2.25	

Order code	Monitoring	Optics	Duration	Lum in emergency mode	Lum in mains mode	Consumption					
						Non Maintained mode		Maintained mode		Battery	
iP65PLA3HCGLC	CGLine+	Lens (L)	3h	510	900	4.4 VA	3.2 W	21.7 VA	10.7 W	4.8 V	4 Ah
iP65PHA3HCGLC		Reflector (H)	3h	380	690	4.4 VA	3.2 W	21.7 VA	10.7 W	4.8 V	4 Ah

One M20 cable gland included

Order code	Scope of supply
IP65PSUSPB	Mounting bracket for chain suspension or for mounting at trunking systems or similar